

# TULLISALI

## Venue info

### 2024

Tullisali.fi



# Tapahumakeskus Tullisali

## Street address

Tyrnäväntie 16, FI-90400 Oulu

## Contact

### Promoter & Artist Production

Jani Suopanki

tel. +358 45 271 4494 | [jani@tullisali.fi](mailto:jani@tullisali.fi)

### Technical Supervisor

Grant Miller

tel. +358 44 243 3274 | [grant.miller@tullisali.fi](mailto:grant.miller@tullisali.fi)







# Capacities

## **Audience capacity**

Max. 1600 persons

## **Seated concert**

apprx. 500 persons

## **Seated gala dinner**

apprx. 400 persons

# Dimensions

- **Main hall area:**  
1 070 m<sup>2</sup>  
(includes the stage and the bar)
- **Hall dimensions:**  
36 x 29 m, height 7.4 m
- **Stage dimensions:**  
11 x 6 m  
Stage height: 1 m from the floor  
Clearance: 4 m

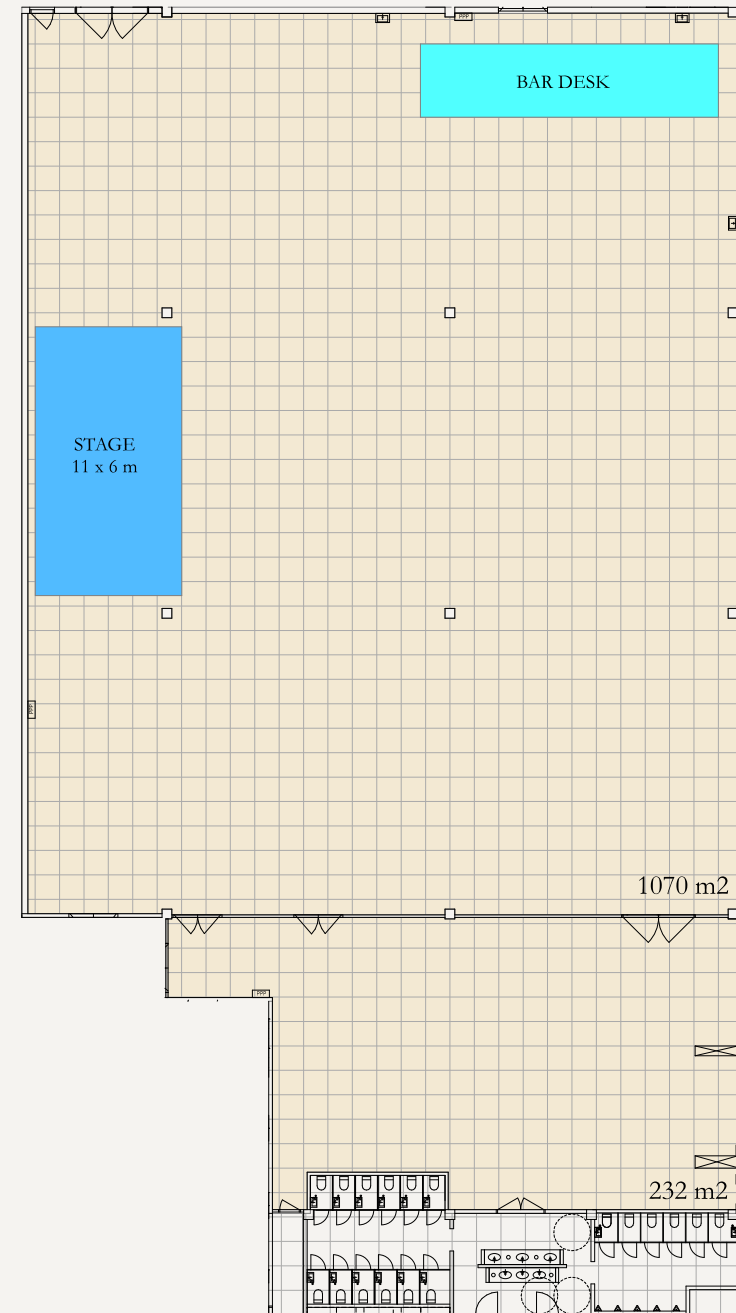

# PA

## Main Pa

- **Line-Array**  
8 (+2) JBL  
Vertec 4888
- **Subs**  
4 x JBL SRX 728s
- **Amplifiers**  
Crown I-Tech 6000 / 8000  
/ 9000

## Stage Monitors

- **Monitors**  
8 x L-Acoustics  
X15HiQ
- **Amplifiers**  
L-Acoustics LA4X
- **Sidefills**  
4 x L-Acoustics Arcs  
+ 4 x SB18m
- **IEMs**  
6 x Sennheiser G3

## Multicores

- 4 x CAT6 Ethercon
- **Digital**  
4 x DMX / AES EBU
- 2 x RG6 BNC

## Mixing Consoles

- Digital Yamaha CL5

# Lights

## Lights Console

- GrandMA2  
onPC / Commanding  
Wing

## Fixtures

- 5 x Selecon  
1 kW Fresnel
- 12 x Clay Paky  
K20 B-eye
- 6 x 8-lite blinder
- 8 x Clay Paky  
Mythos2
- 3 x Martin Atomic 3000
- MDG ATMe hazer
- 24 x Chauvet  
Rogue wash 2
- 8 x ETC  
junior zoom 575

## Patch & Plot

- On separate file,  
download from the link  
below

[Patch and Plot file](#)

## Video

- **Projection surfaces**  
3 x 8 m<sup>2</sup>  
16:9 aspect ratio
- **Projectors**  
3 x Panasonic HD,  
8500ANSI

# Misc Tech Info

## Electricity

- 4 x 63A CEE
- 1 x 32A CEE
- 1 x 16A CEE

## Rigging

- **Backdrop rigging:**  
OK
- **Any additional rigging:**  
Contact venue tech in advance

## Pyro & Special FX

- **Only cold FX by default**  
absolutely no flames and no confetti!
- Please contact the Artist Coordinator in advance!
- All special effects must be organized by authorized company.
- Artist or the service provider must take care of all permits related.

# Arriving, load-in and parking

- **Audience entrance** from the side facing Tyrnäväntie
- **Load-in & cargo** behind the building
  - **Loading dock #4** for vehicles with the tail lift
  - **Loading dock #6** for other vehicles
- Approx. 30 m flat push to the stage
- **Free parking space** behind the building
- **Power for vehicles** available on request



# Arriving, load-in and parking

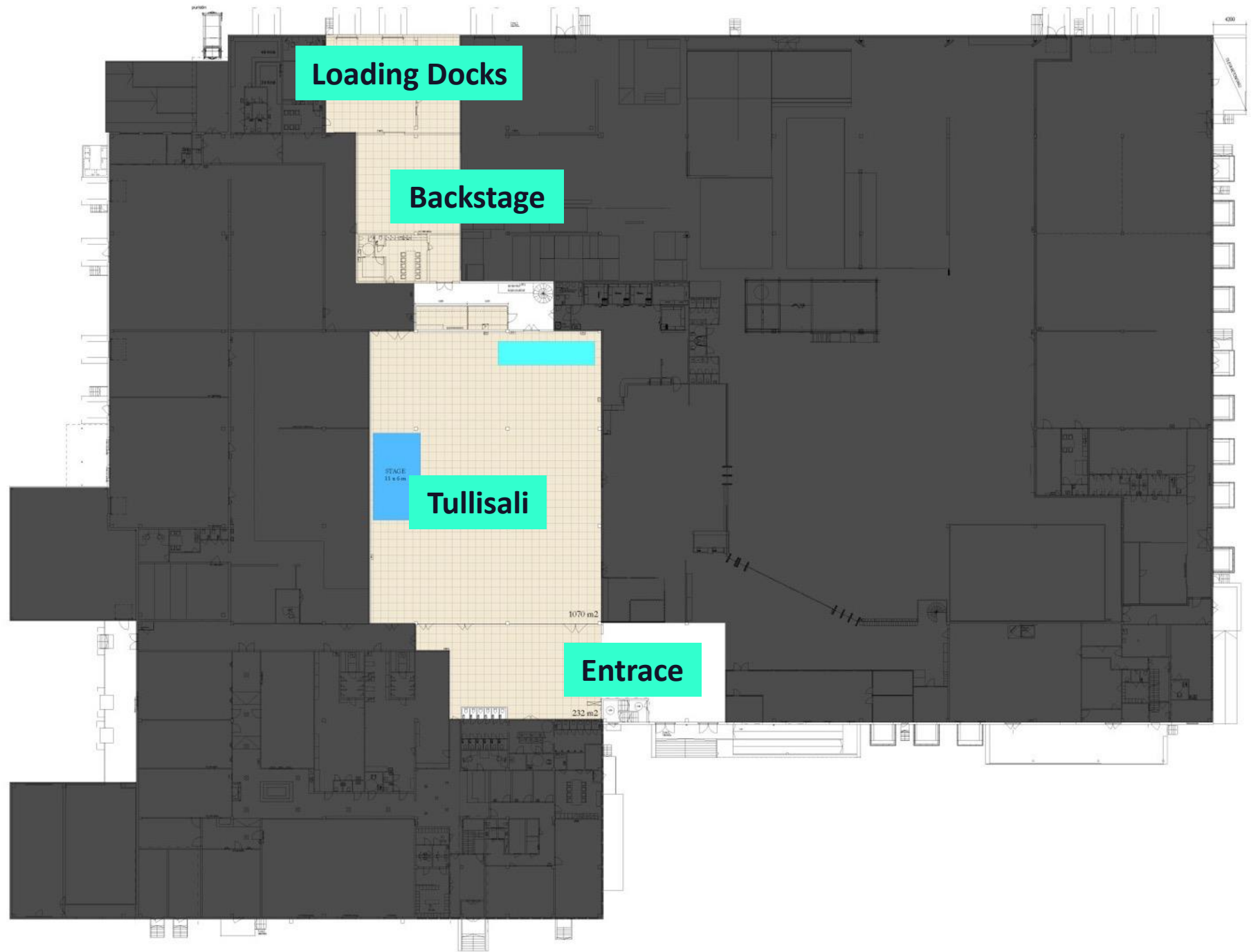

# Backstage

## Main Backstage

- Comfortable for 12 persons
- Fully furnished
- Separate make-up room
- Shower & Toilet

## Additional Backstage

- Comfortable for 8 persons
- Fully furnished

## Internet access

- Wi-Fi available on venue and backstage
- Network name & password laminated in the backstage



# Misc.

## Artist catering

- Buffet-style at the backstage area, provided and served by a restaurant located in the same building

## Merchandise

- Tables and electricity provided by the venue
- Located in the lobby (audience entrance)
- No venue commissions

## Other

- Venue is 100% non-smoking
- Washing machine / dryer available on request, please contact in advance
- Access to the gym next door, please contact in advance
- Authorized ticket sales via Ticketmaster Finland

TAPAHTUMAKESKUS

# TULLISALI

## Contact

**Promoter & Artist Production** Jani Suopanki

tel. +358 45 271 4494 | [jani@tullisali.fi](mailto:jani@tullisali.fi)

**Technical Supervisor** Grant Miller

tel. +358 44 243 3274 | [grant.miller@tullisali.fi](mailto:grant.miller@tullisali.fi)